

When telephoning, please ask for :

David Mitchell

Telephone no :

0115 9148267

Email:

dmitchell@rushcliffe.gov.uk

Date :

19 May 2020

Sharon Pyke
Clerk
Bingham Town Council

By email.

Dear Sharon,

Re: Bingham Leisure Centre and Community Hall

Further to my letter dated 20 January 2020, I am very pleased that the proposed Bingham Leisure Centre and Community Hall received planning permission on 29 April. Our design team have continued to develop the plans ready for tender later this year, assuming market conditions considering Covid-19 are still viable. I promised in my letter in January that I would share further plans with you in due course. As such please find enclosed the most recent designs for the community hall, including the proposed kitchen fit out.

In terms of audio and visual facilities within the community hall, we are currently seeking further grant funding and if successful, will be looking to include, in addition to the 900mm height stage that is included in the design anyway, lighting rigs, sound systems and presentation facilities to enable conference, cinema, theatre, live music and so on. The design team are working with acousticians to ensure that the finishes, particularly the ceiling, enables these uses with appropriate acoustic baffles and finishes where necessary.

In addition to the enhanced AV, lighting and kitchen facilities presented in this latest design iteration, I am also pleased to advise that there will be a permanent platform lift included to ensure accessibility to the stage. I do hope you find these advanced plans agreeable and can see that comments made by the Town Council have been taken on board in developing the designs.

Our member working group have also considered names for the development and propose "Bingham Arena" for the leisure centre and community hall and "Bingham Enterprise Centre" for the office development. I would be interested to hear your views on these names.

If you have any further questions or comments, please do not hesitate to contact me.

Yours sincerely,



Dave Mitchell
Executive Manager – Communities



Rushcliffe Community
Contact Centre

Rectory Road
West Bridgford
Nottingham
NG2 6BU

In person

Monday to Friday
8.30am - 5pm
First Saturday of
each month
9am - 1pm

By telephone

Monday to Friday
8.30am - 5pm

Telephone:

0115 981 9911

Email:

customerservices
@rushcliffe.gov.uk

www.rushcliffe.gov.uk

Postal address

Rushcliffe Borough
Council
Rushcliffe Arena
Rugby Road
West Bridgford
Nottingham
NG2 7YG



Community Hall Kitchen

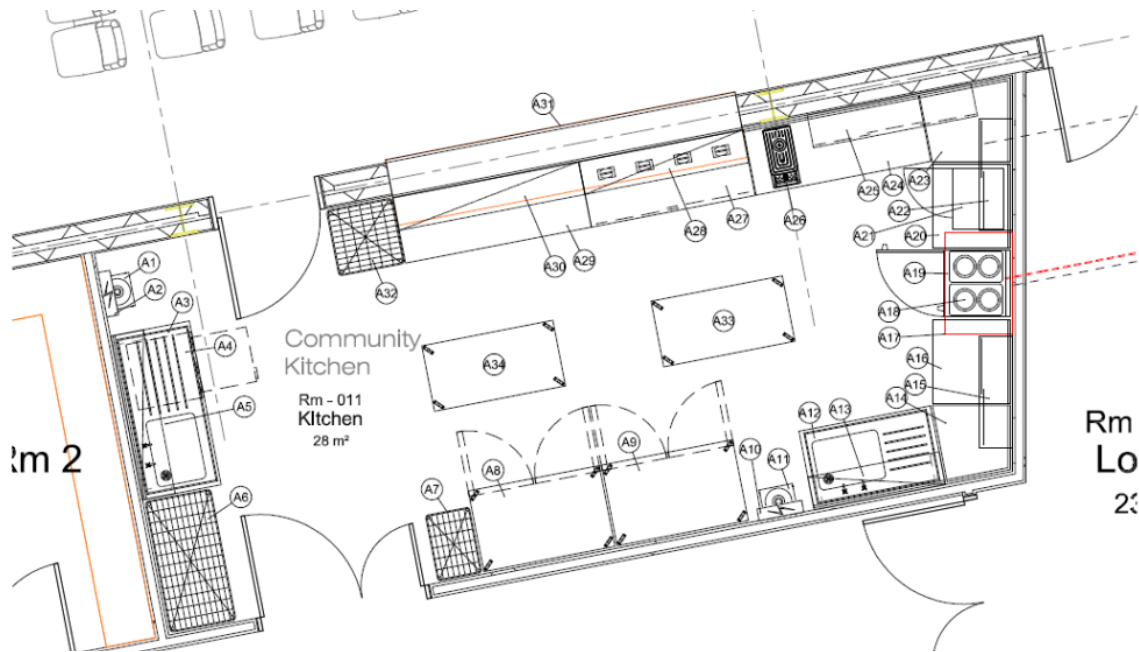

A1	1	Wash Hand Basin - WS2
A2	1	Insect Control Unit
A3	1	Single Bowl Unit
A4	1	Fagor AD-505 Soft Front Loading Dishwasher
A5	1	Wall Shelf - Stock Item
A6	1	Complete Four Tier Storage Rack (Nylon)
A7	1	Complete Four Tier Storage Rack (Chrome)
A8	1	Double Door Upright Freezer (Slimline)
A9	1	Double Door Upright Refrigrerator (Slimline)
A10	1	Insect Control Unit
A11	1	Wash Hand Basin - WS2
A12	1	Single Bowl Unit - Stock Item LHD
A13	1	Wall Shelf - Stock Item
A14	1	Bespoke Wall Bench
A15	1	Wall Cupboard
A16	1	Wall Bench
A17	1	Fume Filtration Unit
A18	1	Electric Four Ring Boiling Top
A19	1	Electric Oven Base Cabinet
A20	1	Wall Bench
A21	1	1100w Professional Microwave Oven
A22	1	Wall Cupboard
A23	1	Bespoke Wall Bench
A24	1	Wall Bench
A25	1	Wall Cupboard
A26	1	Automatic Water Boiler
A27	1	Bespoke Hotcupboard
A28	1	Bespoke Single Tier Heated Overshelf
A29	1	Centre Bench
A30	1	Bespoke Single Tier (Ambient) Overshelf
A31	1	Wall Capping
A32	1	Complete Four Tier Storage Rack (Chrome)
A33	1	Centre Bench
A34	1	Centre Bench

Community Hall Layout

